

DEEPSEA
Power & Light[®]



Multi-SeaCam[®]

The Multi-Purpose, Versatile Workhorse of All Cameras.



FEATURES

Color, Black & White, or Low-Light Black & White

300 Meter or 6000 Meter Depth Rated

Scratch-Resistant Sapphire Port

Interchangeable Camera Modules

Compact Rugged Design

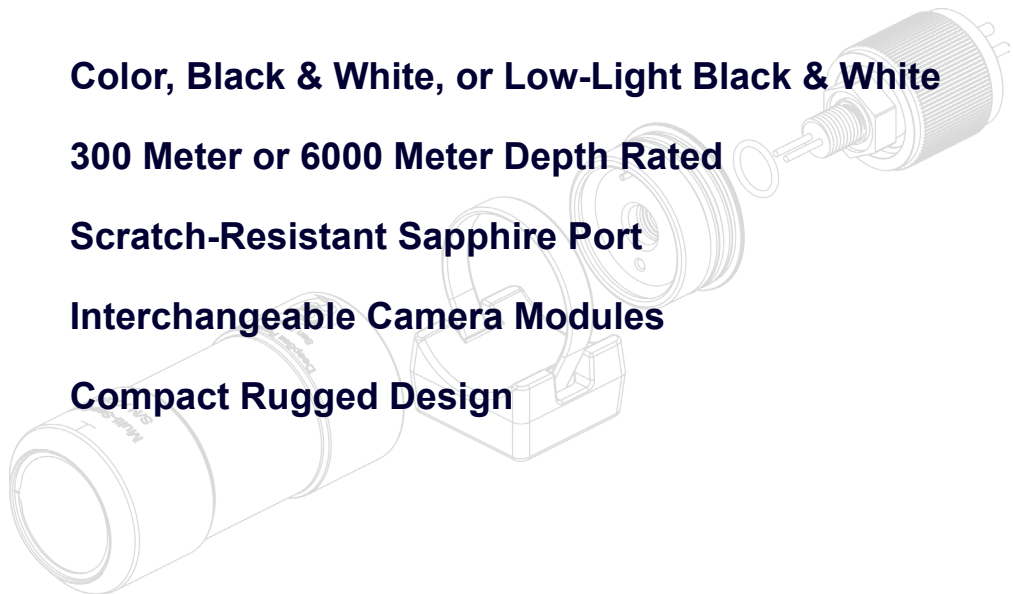

T: (858) 576-1261
F: (858) 576-0219

4033 Ruffin Road
San Diego, CA
92123- 1817 USA

www.deepsea.com
sales@deepsea.com



Multi-SeaCam[®]

Standard Connector



BH4MP

- 1 = Ground
- 2 = Power
- 3 = Video
- 4 = Not Used

*Other connectors and pin-out options are available upon request.

Dimensions

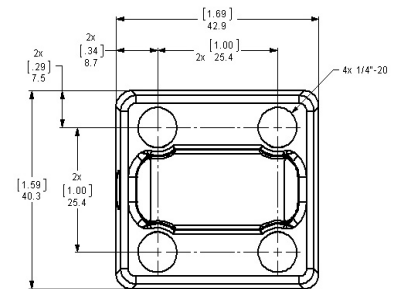
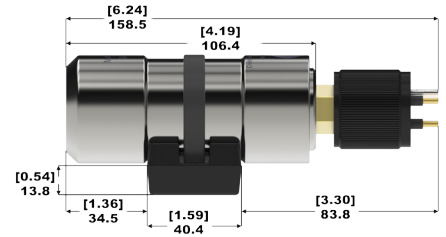
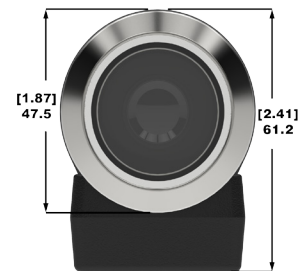

[inch]
mm

	MSC 1050 (B & W)	MSC 1060 (Low-Light B & W)	MSC 2060 (Color)
Mechanical Specifications			
Housing	Delrin or Titanium	Delrin or Titanium	Delrin or Titanium
Port	Sapphire	Sapphire	Sapphire
Outer Diameter	47.5 mm (1.87 in.)	47.5 mm (1.87 in.)	47.5 mm (1.87 in.)
Overall Length (w/o connector)	106.4 mm (4.19 in.)	106.4 mm (4.19 in.)	106.4 mm (4.19 in.)
Weight in Air	Delrin: 296 g (10.5 oz.) Titanium: 459 g (16 oz.)	Delrin: 296 g (10.5 oz.) Titanium: 459 g (16 oz.)	Delrin: 296 g (10.5 oz.) Titanium: 459 g (16 oz.)
Weight in Water	Delrin: 56 g (2 oz.) Titanium: 112 g (4 oz.)	Delrin: 56 g (2 oz.) Titanium: 112 g (4 oz.)	Delrin: 56 g (2 oz.) Titanium: 112 g (4 oz.)
Environmental Specifications			
Depth Rating	Delrin: 300 meters Titanium: 6000 meters	Delrin: 300 meters Titanium: 6000 meters	Delrin: 300 meters Titanium: 6000 meters
Operating Temp.	-20° C to 40° C (-4° F - 104° F)	-10° C to 40° C (14° F to 104° F)	-30° C to 40° C (-22° F to 104° F)
Optical Specifications			
Lens	2.8 mm, f2.8	5 mm, f2.8	3.0 mm, f2.0
Focus	Fixed focus, wide angle	Fixed focus	Fixed focus, wide angle
Depth of Field	10 cm (4 in.) to infinity	30 cm (12 in.) to infinity	10 cm (4 in.) to infinity
FOV in Air	106° (H) x 78° (V) x 149° (D)	77° (H) x 56° (V) x 98° (D)	95° (H) x 75° (V) x 130° (D)
FOV in Water	77° (H) x 59° (V) x 98° (D)	57° (H) x 45° (V) x 71° (D)	75° (H) x 60° (V) x 85° (D)
Video Specifications			
Image Sensor	1/3-inch CCD image sensor	1/2-inch CCD image sensor	1/3-inch CCD image sensor
Number of Pixels	537 (H) x 505 (V) (EIA); 537 (H) x 595 (V) (CCIR)	811 (H) x 508 (V) (EIA); 795 (H) x 596 (V) (CCIR)	768 (H) x 494 (V) (NTSC); 752 (H) x 582 (V) (PAL)
Resolution	400+ TV lines horizontal	570 TV lines horizontal	460 TV lines horizontal
Scene Illumination	0.27 Lux at f2.8	0.01 Lux at f2.8	1.1 Lux at f2.0
Signal to Noise	More than 45 dB	46 dB	More than 45 dB
Video Output	Composite, 1.0 V p-p 75 ohm, Unbalanced	Composite, 1.0 V p-p 75 ohm, Unbalanced	Composite, 1.0 V p-p 75 ohm, Unbalanced
Video Format	EIA (RS170) only	EIA (RS170) or CCIR	NTSC or PAL
Electrical Specifications			
Power	11-30 Volts DC	11-30 Volts DC	11-30 Volts DC
Current	Camera 110 mA	Camera 160 mA	Camera 200mA
Accessory			
	UV cut-out filter for use with UV Mini-SealLite (May Reduce Field of View)		



T: (858) 576-1261
F: (858) 576-0219

4033 Ruffin Road
San Diego, CA
92123-1817 USA

www.deepsea.com
sales@deepsea.com

